



## City of Westminster Licensing Sub-Committee

<b>Meeting:</b>	<i>Licensing Sub-Committee</i>
<b>Date:</b>	<i>24 November 2016</i>
<b>Classification:</b>	<i>General Release</i>
<b>Premises:</b>	<i>No.4 Mayfair, First Floor, 4 Mill Street, London, W1S 2AX</i>
<b>Wards Affected:</b>	<i>West End, Core CAZ North</i>
<b>Financial Summary:</b>	<i>None</i>
<b>Report of:</b>	<i>Director of Public Protection and Licensing</i>

### **1. Executive Summary**

- 1.1 The council has received an application for renewal of the sexual entertainment venue premises licence from Leaserise Ltd for No.4 Mayfair, First Floor, 4 Mill Street, London, W1S 2AX. The report sets out the application details, objection, policy and legal context along with other considerations that the Committee requires to determine this application.

### **2. Recommendations**

- 2.1 That following consideration of the information given orally at the hearing and in writing by the applicants and objectors to:
- 2.1.1 Grant the application in full
  - 2.1.2 Grant the application subject to the standard conditions and/or any modifications to any part of the application and imposition of any additional conditions proposed by a party to the hearing, or
  - 2.1.3 Refuse the application

### **3. Application**

- 3.1 On 15<sup>th</sup> September 2016 the applicant applied to renew the sexual entertainment venue premises licence to provide striptease and hostess services involving full nudity between the hours of 09:00 to 05:00 on each of the days Monday to

Saturday and 12:00 to 22:30 on Sundays. The applicant has not requested to change the relevant entertainment or to remove any standard conditions to the licence if the application is granted. A copy of the application is attached as **Appendix A1**.

- 3.2 The applicant has made further submissions in a letter dated 15 November 2016 (see **Appendix A2**), in which they state the following:
- The SEV application (during the conversion period) was first granted by the Licensing Authority in 2012. Prior to this grant the premises had been trading and providing adult entertainment since 2007 (under the premises licence).
  - The SEV licence has been renewed without objections between 2013 and 2015 (the last 3 years).
  - There are no representations lodged against the application for renewal in 2016 by the relevant authorities.
  - No noise complaints have been notified to the premises.
  - The capacity of the venue is only 30 patrons until 3am, and then just 20 patrons after 3am until close. This is relevant when considering the context of the objection received and the dispersal of patrons at the end of the night. In practice the premises would rarely have the maximum number of patrons on the premises at the same time.
- 3.3 Although the existing licence expired on 30 September 2016, it is deemed to remain in force until the valid renewal application is determined.

#### **4. Objections**

- 4.1 The application has received one objection. Notice of the general terms of the objection has been given to the applicant but the legislation governing Sexual Entertainment Venues does not allow the Licensing Authority to reveal the name or address of the objector to the applicant without the consent of the person making the objection. At the time of publication, the objector has not waived this right.
- 4.2 The objector has stated that they strenuously object to the renewal of the SEV licence. They objected to the new SEV application in 2012 and feel their original concerns remain valid.
- 4.3 The objection made in 2012 stated that the objector felt such a business to be totally inappropriate in the area. They would not have moved to the area if they had known such businesses were planned. They believe the type of people likely to be attracted to such an establishment will create nuisance and noise leading to

potential risks to public safety. The basis for the local economy is professional offices and upscale shopping and eating all of which will be adversely affected if this licence is approved. They would certainly expect our business to suffer if they were to have such neighbours.

- 4.4 Following the objection, the Licensing Service requested further information from the objector as to which concerns they felt were still valid and whether any aspect of the premises or area have changed in the interim since the licence was first granted.
- 4.5 The objector responded by stating that as it was felt that given the objections raised in 2012 were discounted and the Licence granted, any further objections would not influence the granting of the licence in subsequent years. However, they still feel that an establishment of this kind is inappropriate for this area given the majority of businesses are up-scale shops and offices housing professional firms and believe the type of people likely to be attracted to such an establishment will create nuisance and noise leading to potential risks to public safety. They cite an example of an incident on the morning of 28 October 2016 where the police were called to deal with a customer of the night club who was causing a nuisance.
- 4.6 The Licensing Service has made enquiries with the Metropolitan Police regarding the objector's statement above and the Police presence, and can confirm that a CAD record shows that Police did attend an incident in relation to another premises (Maddox Club, 3-5 Mill Street) at 07:54 on 28 October 2016. No offences were recorded and no record has been made in relation to No.4 Mayfair, 4 Mill Street.
- 4.7 The applicant has responded to the objector's statement in their letter dated 15 November 2016 (see **Appendix A2**) as follows:
- Please note that, as mentioned above, the premises did not open in 2012 as the objector asserts. Bearing in mind that the premises began trading in 2007, shows that the premises has successfully operated in a discreet manner, as the objector was not aware when they moved into the area in December 2011, that it even existed. The premises had, at the time the objector moved into the area, been trading for 4 years. The frontage and operation has not changed since 2007 and complies with Westminster's standard conditions for SEV licence in this regard.
  - For clarity there was no incident at the premises on the morning of 28 October 2016. The Police and/ or Local Authority are able to check their records and confirm this. The Police were not called to the premises, and did not attend the premises. The premises has no crime and disorder concerns as verified by the lack of Police objection to this renewal application. There are other licensed premises in the immediate area which could have been the cause of concern for

the objector, which my client is unaware of, but factually there was no Police call out relating to No 4 Mayfair.

- No other objections have been received from local residents or businesses. The applicant enjoys a good relationship with immediate residents and businesses, next door and directly opposite. The immediate neighbourhood (business and residential accommodation in the immediate area) remains unchanged from previous years.
- The premises have been subject to the usual inspections by the Licensing Authority, EH, Police and LFEPA over the years and no immediate issues have been identified in relation to the operation causing their opposition to the renewal applications.

## 5. Licensing Act 2003 Premises Licence

- 5.1 The table below sets out the current activities and times permitted by the premises licence.
- 5.2 A copy of the current Premises Licence is attached to this report as **Appendix B1**.
- 5.3 A copy of the current Sexual Entertainment Venue Licence is attached at **Appendix B2**.

<b><u>Existing Premises Licence (16/09868/LIPCH) permitted Licensable Activities</u></b>
<b>Regulated Entertainment: Indoors</b>
<b>Performance of Dance:</b> Monday to Saturday: 09:00 to 05:00 Sunday: 12:00 to 22:30
<b>Exhibition of a Film:</b> Monday to Saturday: 09:00 to 05:00
<b>Performance of Live Music:</b> Monday to Saturday: 09:00 to 05:00 Sunday: 12:00 to 22:30
<b>Playing of Recorded Music:</b> Unrestricted
<b>Anything of a similar description to Live Music, Recorded Music or Performance of Dance:</b> Monday to Saturday: 09:00 to 05:00 Sunday: 12:00 to 22:30

<p><b>Late Night Refreshment: Indoors</b></p> <p>Monday to Saturday 23:00 to 05:00</p>
<p><b>Sale of Alcohol: On and off the premises</b></p> <p>Monday to Saturday 10:00 to 05:00 Sunday 12:00 to 22:30</p>
<p><b>Capacity:</b></p> <p>Condition 15 on the LA03 Premises Licence limits the number of persons accommodated at any one time (excluding staff) to 30, save that on Monday to Friday after 03:00 hours (the following morning) the number of customers on the premises at any one time is limited to 20 persons (excluding staff).</p>
<p><b>Opening hours:</b></p> <p>Monday to Saturday 09:00 to 05:30 Sunday 12:00 to 23:00</p>

## 6. Policy Considerations

### 6.1 Suitability of applicant – SU1

The applicant has stated that no relevant offences have been committed. In addition the Police and the Council's Licensing Inspectorate have carried out fit and proper persons checks and have not made any objections to the application.

### 6.2 SEV carried on for the benefit of another person – SU2

The Police and the Council's Licensing Inspectorate have undertaken appropriate checks and have made no comments.

### 6.3 Appropriate number of SEV in a locality – NO1

The appropriate number of sexual entertainment venues in the relevant localities is 25 in the Westminster core CAZ north. As the premises are currently licensed this application, if granted, will not exceed 25.

### 6.4 Character of the relevant locality – LO1

The character of the area is largely office, retail and food and drink led premises. There is not a high concentration of residential premises within the locality. St George's Church is of historic note. However, the premises is located in the

street at the rear of the premises and Mill Street is not a major traffic or pedestrianised route.

#### 6.5 Use of premises in the vicinity – LO2

The premises within the vicinity are predominantly office buildings with retail units on the ground floor. The neighbouring premises to this venue are a public house and barber shop. The rear of St George's Church is located at the end of Mill Street, Junction with Maddox Street and is in very close proximity to the applicants premises. There are some residential premises which are located above retail and office premises. A map showing the premises uses in the area and residential premises is attached as **Appendix C**.

#### 6.6 Layout, character or condition of the venue - L03

The premises is predominantly contained on the first floor of the building. The ground floor consists only of the entrance door and a stairway leading into the premises. The first floor of the premises consists of a bar area at the top of the stairs and then a small room with a stage and pole in one corner and a seating area around the perimeter of the rest of the room.

### 7. **Legal Implications**

7.1 The Licensing Sub-Committee may determine to:

- (a) Grant the application in full
- (b) Grant with additional special conditions which the Licensing Sub-Committee deem appropriate; or
- (b) Refuse the application.

7.2 Before refusing to renew the licence, the Licensing Authority shall give the holder an opportunity to appear before and be heard by the Licensing Sub-Committee (Para 10(19) Schedule 3 LG(MP)A1982).

7.3 In considering this application, the Licensing Sub-Committee shall have regard to any observations submitted to them by the Chief Officer of Police and any objections that have been received in writing within the 28 day consultation period (Para 10(18) Schedule 3 LG(MP)A1982).

7.4 The Licensing Sub-Committee may refuse to renew the licence on one or more of the following grounds as set out in Paragraph 12(3) of Schedule 3 LG(MP)A 1982):

- (a) that the applicant is unsuitable to hold a licence by reason of having been convicted of an offence or for any other reason;
- (b) that if the licence were to be granted the business to which it relates would be managed by or carried on for the benefit of a person, other than the

- applicant, who would be refused the grant of such a licence if he made the application himself;
- (c) that the number of sex establishments in the relevant locality at the time the application is *made* [determined] is equal to or exceeds the number which the authority consider is appropriate for that locality;
  - (d) that the grant or renewal of the licence would be inappropriate, having regard—
    - (i) to the character of the relevant locality; or
    - (ii) to the use to which any premises in the vicinity are put; or
    - (iii) to the layout, character or condition of the premises, vehicle, vessel or stall in respect of which the application is made.

7.5 If the Licensing Sub-Committee determine to renew the Sexual Entertainment Venue licence, the licence will be subject to the Standard Conditions for Sexual Entertainment Venue licences, unless the Sub-Committee determines that certain Standard Conditions should be expressly excluded or varied (Para 13(4) Schedule 3 LG(MP)A1982).

7.6 Should the Licensing Sub-Committee determine to refuse the application for the renewal of the licence under Paragraph 12(3)(a) or (b) Schedule 3 LG(MP)A 1982, the applicant may appeal to the Magistrates' Court within 21 days beginning with the date on which the applicant is notified of the refusal of his application (Para 27(1) Schedule 3 LG(MP)A1982). The licence is deemed to remain in force until the time for bringing an appeal has ended and, if such an appeal is brought, until the determination or abandonment of the appeal.

## **8. Human Rights Act and Equalities Act**

8.1 In making a decision consideration will need to be given to the applicants rights under the European Convention on Human Rights. The right to peaceful enjoyment of possessions (Article 1 of the First Protocol) and freedom of expression (Article 10) may be relevant. The Home Office Guidance suggests that "local authorities would be well advised to consider whether any interference with the applicants rights under Article 10 or Article 1, Protocol 1 of the European Convention on Human Rights is necessary and proportionate for the prevention of disorder or crime, for the protection of health or morals or for the protection of the rights and freedoms of other, or in the case of Article 1, Protocol 1, can be justified in the general interest".

### **Appendices**

A1 – Application Form

A2 – Applicant's further submissions dated 15 November 2016

B1 – Current Licensing Act 2003 Premises Licence

B2 – Current Sexual Entertainment Venue Licence

C – Map of the locality

**If you have any queries about this Report or wish to inspect any of the Background Papers please contact: Nick Nelson on 020 7641 3431 or at [nnelson@westminster.gov.uk](mailto:nnelson@westminster.gov.uk)**

## **BACKGROUND PAPERS**

Local Government (Miscellaneous Provisions) Act 1982

Policing and Crime Act 2009

Sexual Entertainment Venues Statement of Licensing Policy 2012

Sexual Entertainment Venues Guidance and Procedure effective 17 February 2012



2



City of Westminster



# APPLICATION TO RENEW A SEXUAL ENTERTAINMENT VENUE LICENCE

IMPORTANT: This form is open to inspection by the public.

**Leaserise Limited**

I / We .....  
(Insert name(s) of applicant)

apply to renew the Sexual Entertainment Venue licence under the Local Government (Miscellaneous Provisions) Act 1982 for the following premises:

**No.4 Mayfair**

Premises name: .....

**First Floor, 4 Mill Street, London W1S 2AX**

Premises address: .....

**15/08368/LISEVR**

Licence reference number: .....

**Important Note:** Before completing this application, please read the following:

- WCC's Statement of Licensing Policy for Sexual Entertainment Venues
- WCC's Standard Conditions for Sexual Entertainment Venues
- WCC's Rules of Procedure governing Sexual Entertainment Venue applications

## PART 1 – Applicant Details

Please state whether you are renewing the Sexual Entertainment Venue licence as:

a) an individual or individuals  complete section (A)

b) a person other than an individual:

i. as a body corporate  complete section (B)

ii. as an unincorporated body  complete section (B)

**Section A – Individual Licensee Details**

First name(s):	
Surname:	
Former names (if any):	
Title:	
Home address:	
Postcode:	
Email address:	
Contact telephone number:	
Date of Birth:	
Have you been a resident of an EEA state throughout the period of 6 months immediately preceding the date the application was made?	Yes <input type="checkbox"/> No <input type="checkbox"/>

**Additional Licensee Details (if necessary)**

First name(s):	
Surname:	
Former names (if any):	
Title:	
Home address:	
Postcode:	
Email address:	
Contact telephone number:	
Date of Birth:	
Have you been a resident of an EEA state throughout the period of 6 months immediately preceding the date the application was made?	Yes <input type="checkbox"/> No <input type="checkbox"/>

### Section B – Body Corporate or Unincorporated Body Details

Business Name: (if your business is registered, use its registered name)	Leaserise Limited
Is your business registered in the UK with Companies House?	Yes <input checked="" type="checkbox"/>
	Registered Number: 03688401
Is your business registered in another EEA state:	No <input type="checkbox"/>
	Yes <input type="checkbox"/>
	EEA State: Registered Number:
	No <input checked="" type="checkbox"/>
Legal Status: (e.g. Company Partnership, etc)	Limited Company
Home Country: (the country where the headquarters of your business is located)	England
Registered Address:	Units 3-5 Croxted Mews, 286a/288 Croxted Road, London
Postcode:	SE24 9DA
<b>Directors, Partners, Owners and Managers</b>	
You must provide details of all DIRECTORS (if the applicant is a company), all PARTNERS (if it is a partnership), and all MANAGERS of the business or organisation, including day-to-day MANAGERS OF THE PREMISES.	
Have there been any changes to the directors, partners or managers involved with the premises?	Yes <input checked="" type="checkbox"/> (please see below) No <input type="checkbox"/>
If yes, please provide details of the changes on a separate sheet, including the full name, private address and capacity of each director, partner and manager involved with the operation of the premises.	

Full name:	Richard Jones (address change)
Private address:	85A Laleham Road Staines TW18 2EA
Capacity:	Director
<b>Please use a separate sheet if necessary- see attached</b>	

**Other Business Interests**

Is the applicant, or any person named in this application, involved in any way with any other sex establishment (e.g. sexual entertainment venue, sex shop, sex cinema, hostess bar)?

Yes  (please complete below)      No

Please provide details, including the name and address of the establishment and the nature and extent of the interest. (If necessary please provide a separate sheet).

**PART 2 – Premises Details**

Premises name:	No.4 Mayfair
Premises address:	First Floor 4 Mill Street London
Postcode:	W1S 2AX
Premises telephone number:	020 7493 0561
Email:	
Website address:	

Where the licence is for a vehicle, vessel or stall, state where it is used as a sexual entertainment venue:	N/A
Have there been any changes to the nature of the relevant entertainment since the licence was last granted / renewed?	Yes <input type="checkbox"/> No <input checked="" type="checkbox"/> If yes, please provide details below.

### **PART 3 – Convictions / Disqualifications**

Have you, or any person named in or associated with this application, been convicted of any crime or offence?
Yes <input type="checkbox"/> No <input checked="" type="checkbox"/> If yes, please provide details on a separate sheet
Have you been refused the renewal of a licence for this premises, vehicle, vessel or stall within the last 12 months?
Yes <input type="checkbox"/> No <input checked="" type="checkbox"/> If yes, has the refusal been reversed on appeal?
Yes <input type="checkbox"/> No <input type="checkbox"/>
Have you had a sex establishment licence revoked in Westminster within the last 12 months?
Yes <input type="checkbox"/> No <input checked="" type="checkbox"/>

### **PART 4 - Checklist**

Please tick as appropriate:

All relevant sections of the application form have been completed in full	<input checked="" type="checkbox"/>
Payment of the fee has been made in full (refer to Part 6 of this form)	<input checked="" type="checkbox"/>

Notice of this application has been published in a local newspaper / will be published in a local newspaper within the next 7 days, a full copy of the newspaper to be provided to the Licensing Authority as soon as possible	X
Notice of this application has been displayed at the premises	X
The application has been served on the Metropolitan Police Service	X

## PART 5 - Declaration

**APPLICANTS ARE WARNED THAT ANY PERSON WHO, IN CONNECTION WITH AN APPLICATION FOR THE RENEWAL OF A LICENCE MAKES A FALSE STATEMENT WHICH HE KNOWS TO BE FALSE IN ANY MATERIAL RESPECT, OR WHICH HE DOES NOT BELIEVE TO BE TRUE, IS GUILTY OF AN OFFENCE AND LIABLE ON SUMMARY CONVICTION TO A FINE NOT EXCEEDING TWENTY THOUSAND POUNDS (£20,000).**

Lana Tricker

I ..... declare that the information given above is true and complete in every respect.

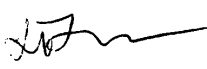
Signed	
Date:	15 September 2016
Capacity:	Solicitor for the Applicant

For joint applications:

Signed	
Date:	
Capacity:	

### Agent Details

Are you an authorised agent acting on behalf of the applicant?

Yes  No

If yes, please provide the following:

Agent name:	Lana Tricker, LT Law
Agent Address:	18 Soho Square London
Postcode:	W1D 3QL
Agent Telephone Number:	020 3755 5138
Agent Email:	Lana@ltlaw.co.uk

### Correspondence Details

Please provide the details to which all correspondence should be sent:

Name:	Lana Tricker, LT Law
Address:	18 Soho Square London
Postcode:	W1D 3QL
Telephone Number:	020 3755 5138
Email:	lana@ltlaw.co.uk

## **PART 6 – Payment**

If applying by post you can pay by cheque, postal order or credit / debit card. Please make cheques and postal orders payable to 'City of Westminster'.

If you would like to pay by credit / debit card please complete this section:

Type of credit / debit card:	Visa <input type="checkbox"/>	MasterCard <input type="checkbox"/>
	Solo <input type="checkbox"/>	Maestro <input type="checkbox"/> Delta <input type="checkbox"/>
Card number:		
Issue date:	/	(mm/yy)
Expiry date:	/	(mm/yy)
Issue number:	(for Maestro / Solo)	
Name on card:		
Amount (£):		

**THIS APPLICATION SHOULD BE COMPLETED IN FULL AND RETURNED TO THE LICENSING SERVICE, PREMISES MANAGEMENT, WESTMINSTER CITY HALL, 64 VICTORIA STREET, LONDON, SW1E 6QP.**



18 Soho Square, London W1D 3QL

15 November 2016

Nick Nelson  
Licensing Team  
Westminster City Council  
Westminster City Hall  
4<sup>th</sup> Floor, 64 Victoria Street  
London SW1E 6QP

**By Email**

Our ref: LT/1332

Dear Nick

**RE: NO.4 MAYFAIR, FIRST FLOOR, 4 MILL STREET, LONDON W1S 2AX – APPLICATION FOR RENEWAL OF A SEXUAL ENTERTAINMENT VENUE LICENCE**

I act for Leaserise Limited and refer to the hearing scheduled on this matter for 24 November 2016 to hear the 2016 renewal application for the SEV licence held for the premises.

One objection has been received against the renewal application for 2016 and in response I comment as follows:

- The SEV application (during the conversion period) was first granted by the Licensing Authority in 2012. Prior to this grant the premises had been trading and providing adult entertainment since 2007 (under the premises licence).
- The SEV licence has been renewed without objections between 2013 and 2015 (the last 3 years).
- There are no representations lodged against the application for renewal in 2016 by the relevant authorities.
- No noise complaints have been notified to the premises.
- The capacity of the venue is only 30 patrons until 3am, and then just 20 patrons after 3am until close. This is relevant when considering the context of the objection received and the dispersal of patrons at the end of the night. In practice the premises would rarely have the maximum number of patrons on the premises at the same time.
- The objector states in their representation that they objected to the original grant of a SEV application, which were in the following terms:

*“(We) wish to strenuously object to this licence application as we consider such a business to be totally inappropriate in this area. Indeed we only moved here in December and would not have done so if we had known such businesses were planned. We believe the type of people likely to be attracted to such an establishment will create nuisance and noise leading to*

Lana Tricker; SRA No 488281 T: +44 (0)20 3755 5138 F: +44 (0)20 7025 8132 E: [office@lrlaw.co.uk](mailto:office@lrlaw.co.uk)

Authorised and Regulated by the Solicitors Regulation Authority





Licensing Team  
Westminster City Council

---

*potential risks to public safety. The basis for the local economy is professional offices and up scale shopping and eating all of which will be adversely affected if this license is approved. We would certainly expect our business to suffer if we were to have such neighbours. We therefore ask you to reject the licence application."*

Please note that, as mentioned above, the premises did not open in 2012 as the objector asserts. Bearing in mind that the premises began trading in 2007, shows that the premises has successfully operated in a discreet manner, as the objector was not aware when they moved into the area in December 2011, that it even existed. The premises had, at the time the objector moved into the area, been trading for 4 years. The frontage and operation has not changed since 2007 and complies with Westminster's standard conditions for SEV licence in this regard.

- On 28 October 2016 the objector furthered their representation by stating:

*"We still feel that an establishment of this kind is inappropriate for this area given the majority of business are up-scale shops and offices housing professional firms and believe the type of people likely to be attracted to such an establishment will create nuisance and noise leading to potential risks to public safety. Indeed we have had an incident this morning where the police were called to deal with a customer of the night club who was causing a nuisance."*

For clarity there was no incident at the premises on the morning of 28 October 2016. The Police and/ or Local Authority are able to check their records and confirm this. The Police were not called to the premises, and did not attend the premises. The premises has no crime and disorder concerns as verified by the lack of Police objection to this renewal application. There are other licensed premises in the immediate area which could have been the cause of concern for the objector, which my client is unaware of, but factually there was no Police call out relating to No 4 Mayfair.

- No other objections have been received from local residents or businesses. The applicant enjoys a good relationship with immediate residents and businesses, next door and directly opposite. The immediate neighbourhood (business and residential accommodation in the immediate area) remains unchanged from previous years.
- The premises have been subject to the usual inspections by the Licensing Authority, EH, Police and LFEPA over the years and no immediate issues have been identified in relation to the operation causing their opposition to the renewal applications.

Should you have any questions please do not hesitate to contact Lana Tricker on 020 3755 5138.

Yours faithfully  
**LT LAW**



Schedule 12  
Part A

WARD: West End  
UPRN: 100023607916

## City of Westminster

64 Victoria Street, London, SW1E 6QP

Premises licence

Regulation 33, 34

Premises licence number:

16/09868/LIPCH

Original Reference:

05/04986/LIPCV

### Part 1 – Premises details

#### Postal address of premises:

No 4 Mayfair  
First Floor  
4 Mill Street  
London  
W1S 2AX

Telephone Number: 020 7493 0561

#### Where the licence is time limited, the dates:

Not applicable

#### Licensable activities authorised by the licence:

Performance of Dance  
Exhibition of a Film  
Performance of Live Music  
Playing of Recorded Music  
Anything of a similar description to Live Music, Recorded Music or Performance of Dance  
Late Night Refreshment  
Private Entertainment consisting of dancing, music or other entertainment of a like kind for consideration and with a view to profit  
Sale by Retail of Alcohol

#### The times the licence authorises the carrying out of licensable activities:

##### Performance of Dance

Monday to Saturday: 09:00 to 05:00  
Sunday: 12:00 to 22:30

##### Exhibition of a Film

Monday to Saturday: 09:00 to 05:00  
Non-standard Timings: See conditions 46 and 47

##### Performance of Live Music

Monday to Saturday: 09:00 to 05:00  
Sunday: 12:00 to 22:30

##### Playing of Recorded Music

Unrestricted

**Anything of a similar description to Live Music, Recorded Music or Performance of Dance**

Monday to Saturday: 09:00 to 05:00  
Sunday: 12:00 to 22:30

**Late Night Refreshment**

Monday to Saturday: 23:00 to 05:00

**Private Entertainment consisting of dancing, music or other entertainment of a like kind for consideration and with a view to profit** Unrestricted

**Sale by Retail of Alcohol**

Monday to Saturday: 10:00 to 05:00  
Sunday: 12:00 to 22:30

*For times authorised for Christmas and New Year see conditions at Annex 1 and 3*

**The opening hours of the premises:**

Monday to Saturday: 09:00 to 05:30  
Sunday: 12:00 to 23:00

**Where the licence authorises supplies of alcohol, whether these are on and/or off supplies:**

Alcohol is supplied for consumption both on and off the Premises.

**Part 2**

**Name, (registered) address, telephone number and email (where relevant) of holder of premises licence:**

Leaserise Ltd  
Units 3-5 Croxted Mews  
286a/288 Croxted Road  
London  
SE24 9DA

**Registered number of holder, for example company number, charity number (where applicable)**

03688401

**Name, address and telephone number of designated premises supervisor where the premises licence authorises the supply of alcohol:**

**Name:** Isabelle Hooper-Jones

***Please note: It is the policy of the Licensing Authority not to display the address details of a designated premises supervisor.***

**Personal licence number and issuing authority of personal licence held by designated premises supervisor where the premises licence authorises for the supply of alcohol:**

**Licence Number:** 14/00028/LAPER  
**Licensing Authority:** Spelthorne Borough Council

**Date:** 18 September 2016

**This licence has been authorised by Mr Yiannis Chrysanthou on behalf of the Director - Public Protection and Licensing.**

## Annex 1 – Mandatory conditions

1. No supply of alcohol may be made at a time when there is no designated premises supervisor in respect of this licence.
2. No supply of alcohol may be made at a time when the designated premises supervisor does not hold a personal licence or the personal licence is suspended.
3. Every supply of alcohol under this licence must be made or authorised by a person who holds a personal licence.
4.
  - (1) The responsible person must ensure that staff on relevant premises do not carry out, arrange or participate in any irresponsible promotions in relation to the premises.
  - (2) In this paragraph, an irresponsible promotion means any one or more of the following activities, or substantially similar activities, carried on for the purpose of encouraging the sale or supply of alcohol for consumption on the premises—
    - (a) games or other activities which require or encourage, or are designed to require or encourage, individuals to;
      - (i) drink a quantity of alcohol within a time limit (other than to drink alcohol sold or supplied on the premises before the cessation of the period in which the responsible person is authorised to sell or supply alcohol), or
      - (ii) drink as much alcohol as possible (whether within a time limit or otherwise);
    - (b) provision of unlimited or unspecified quantities of alcohol free or for a fixed or discounted fee to the public or to a group defined by a particular characteristic in a manner which carries a significant risk of undermining a licensing objective;
    - (c) provision of free or discounted alcohol or any other thing as a prize to encourage or reward the purchase and consumption of alcohol over a period of 24 hours or less in a manner which carries a significant risk of undermining a licensing objective;
    - (d) selling or supplying alcohol in association with promotional posters or flyers on, or in the vicinity of, the premises which can reasonably be considered to condone, encourage or glamorise anti-social behaviour or to refer to the effects of drunkenness in any favourable manner;
    - (e) dispensing alcohol directly by one person into the mouth of another (other than where that other person is unable to drink without assistance by reason of a disability).
5. The responsible person must ensure that free potable water is provided on request to customers where it is reasonably available.
6.
  - (1) The premises licence holder or club premises certificate holder must ensure that an age verification policy is adopted in respect of the premises in relation to the sale or supply of alcohol.
  - (2) The designated premises supervisor in relation to the premises licence must ensure that the supply of alcohol at the premises is carried on in accordance with the age verification policy.

- (3) The policy must require individuals who appear to the responsible person to be under 18 years of age (or such older age as may be specified in the policy) to produce on request, before being served alcohol, identification bearing their photograph, date of birth and either—
  - (a) a holographic mark, or
  - (b) an ultraviolet feature.
  
- 7. The responsible person must ensure that—
  - (a) where any of the following alcoholic drinks is sold or supplied for consumption on the premises (other than alcoholic drinks sold or supplied having been made up in advance ready for sale or supply in a securely closed container) it is available to customers in the following measures—
    - (i) beer or cider: ½ pint;
    - (ii) gin, rum, vodka or whisky: 25 ml or 35 ml; and
    - (iii) still wine in a glass: 125 ml;
  - (b) these measures are displayed in a menu, price list or other printed material which is available to customers on the premises; and
  - (c) where a customer does not in relation to a sale of alcohol specify the quantity of alcohol to be sold, the customer is made aware that these measures are available.

A responsible person in relation to a licensed premises means the holder of the premise licence in respect of the premises, the designated premises supervisor (if any) or any individual aged 18 or over who is authorised by either the licence holder or designated premises supervisor. For premises with a club premises certificate, any member or officer of the club present on the premises in a capacity that which enables him to prevent the supply of alcohol.

- 8(i) A relevant person shall ensure that no alcohol is sold or supplied for consumption on or off the premises for a price which is less than the permitted price.
  
- 8(ii) For the purposes of the condition set out in paragraph 8(i) above -
  - (a) "duty" is to be construed in accordance with the Alcoholic Liquor Duties Act 1979;
  - (b) "permitted price" is the price found by applying the formula -
 
$$P = D + (D \times V)$$
 Where -
    - (i) P is the permitted price,
    - (ii) D is the amount of duty chargeable in relation to the alcohol as if the duty were charged on the date of the sale or supply of the alcohol, and
    - (iii) V is the rate of value added tax chargeable in relation to the alcohol as if the value added tax were charged on the date of the sale or supply of the alcohol;
  - (c) "relevant person" means, in relation to premises in respect of which there is in force a premises licence -
    - (i) the holder of the premises licence,

- (ii) the designated premises supervisor (if any) in respect of such a licence, or
  - (iii) the personal licence holder who makes or authorises a supply of alcohol under such a licence;
- (d) "relevant person" means, in relation to premises in respect of which there is in force a club premises certificate, any member or officer of the club present on the premises in a capacity which enables the member or officer to prevent the supply in question; and
- (e) "value added tax" means value added tax charged in accordance with the Value Added Tax Act 1994.
- 8(iii). Where the permitted price given by Paragraph 8(ii)(b) above would (apart from this paragraph) not be a whole number of pennies, the price given by that sub-paragraph shall be taken to be the price actually given by that sub-paragraph rounded up to the nearest penny.
- 8(iv). (1) Sub-paragraph 8(iv)(2) below applies where the permitted price given by Paragraph 8(ii)(b) above on a day ("the first day") would be different from the permitted price on the next day ("the second day") as a result of a change to the rate of duty or value added tax.
- (2) The permitted price which would apply on the first day applies to sales or supplies of alcohol which take place before the expiry of the period of 14 days beginning on the second day.
9. All persons guarding the premises against unauthorised access or occupation or against outbreaks of disorder or against damage (door supervisors) must be licensed by the Security Industry Authority.
10. Admission of children to the premises must be restricted in accordance with the film classification recommended by the British Board of Film Classification or recommended by this licensing authority as appropriate.

**Conditions reproducing the effect of conditions subject to which relevant existing licences have effect.**

**Condition relating to Regulated Entertainment**

11. This licence is subject to all the former Rules of Management for Places of Public Entertainment licensed by Westminster City Council, in force from 4 September 1998 and incorporating amendments agreed by the Council on 25 October 1999, 30 June 2000, 16 January 2001 and 1 October 2001.
12. On New Year's Eve the premises can remain open for the purpose of providing regulated entertainment from the time when the provision of regulated entertainment must otherwise cease on New Year's Eve to the time when regulated entertainment can commence on New Year's Day (or until midnight on New Year's Eve where no regulated entertainment takes place on New Year's Day).
13. Notwithstanding the provisions of Rule of Management No. 6 the premises may remain open for the purposes of this licence from 11pm on each of the days Monday to Saturday to 5am on the day following,

14.\* Notwithstanding the provisions of Rule of Management No. 4 entertainment by way of traditional striptease may be provided. With the exception of the performers during their performance, all other persons to be decently attired whilst on the premises.

15. The number of persons accommodated at any one time (excluding staff) shall not exceed; 30, save that on Monday to Friday after 03:00 hours (the following morning),

the number of customers on the premises at any one time is limited to 20 persons (excluding staff).

16\*. A code of conduct will be lodged with the police and Westminster City Council Licensing Inspectorate. The club will provide a copy of which to all hostesses who will read, sign and comply with the document.

17\*. Individual records shall be kept at the premises of the real names, stage names and addresses of all hostesses working at the premises

18\*. All final bills will include the number of customers and names of hostesses in the party. Patrons will sign a copy of the bill. The club will retain the bills for at least 90days, and will make them available to police upon request.

19. There shall be no soliciting for custom by means of persons on the highway or any payment made to them by or on behalf of the licensees.

20\*. No patrons under 21 shall be permitted whilst the premises are operating as a hostess bar or whilst the performance of striptease or nudity are taking place. A notice restricting the admission of under 21-year olds is to be prominently displayed at the entrance of the premises.

#### **Conditions for Sale of Alcohol**

21. Substantial food and suitable beverages other than intoxicating liquor (including drinking water) shall be available during the whole of the permitted hours in all parts of the premises where intoxicants are provided.
22. On any evening where the premises or part of the premises are open for the sale or supply or provision of any of the following:- alcohol, music, dance or entertainment, intoxicating liquor may not be sold or supplied to persons admitted to the premises other than to:
- (a) persons who have paid a minimum admission fee of at least £5 Monday to Thursday, and £7 Friday to Sunday for music, dancing and entertainment (not to be credited against consumables) OR
  - (b) Persons who have paid a minimum £150 payable in advance for music, dancing and entertainment (not to be credited against consumables). A list of all persons who have paid an annual admission fee will be held at reception for inspection by the relevant authority; OR
  - (c) Any person attending a private function at the premises, details of the type of function, host and list of persons attending having been provided to Police at least 24 hours previously; OR
  - (d) Artistes or person employed on the premises; OR
  - (e) Bona fide guests of the proprietor (not exceeding 10% of the total capacity for the premises as specified in the Public Entertainment Licence for the premises), a list of whom shall be kept at reception for inspection by appropriate authorities; OR
  - (f) Persons taking full table meals a list of whom are held at reception for inspection by the relevant authorities.
23. There will be no corporate memberships.
24. Membership is not transferable.



25\*. A code of conduct will be lodged with the Police and a copy with the Clerk to the Licensing Justices, a copy of this code of conduct will be provided by the club to all hostesses who will read, sign and comply with the document.

26. The licensees will engage the service of a covert patron to visit the premises at least twice a year to ensure the code of conduct is being complied with. All visits will be recorded in a formal report and provided directly to the licensees and the police.

27\*. Individual records shall be kept at the premises of the real names, stage names and addresses of all hostesses working at the premises. The record will include either a copy of their current passport, EU driving licence or national identity card. When the record form has been completed and will be sent to the police 24 hours before a hostess starts working at the premises.

28. All final bills will include the number of customers and names of hostesses in the party. Patrons will sign a copy of the bill. The club will retain the bills for at least 90 days, and will make them available to police upon request.

29\*. There shall be no soliciting for custom by means of persons on the highway or any payment made to them by or on behalf of the licensees.

30\*. No striptease or nudity, all persons to be decently attired except where permitted by a relevant authority.

31\*. No patrons under 21 shall be permitted whilst the premises are operating as a hostess bar.

**Conditions which reproduce the effect of any restriction imposed on the premises by specified enactments**

**Conditions for Sale of Alcohol**

32. Permitted hours on Sundays:

- (a) On Sundays, other than Christmas Day or New Year's Eve, 12.00 noon to 22.30.
- (b) On New Year's Eve on a Sunday, 12.00 to 22.30.
- (c) On New Year's Eve from the end of permitted hours on New Year's Eve to the start of permitted hours on the following day (or, if there are no permitted hours on the following day, 00.00 midnight on 31st December).

NOTE - The above restrictions do not prohibit:

- (a) during the first twenty minutes after the above hours the consumption of the alcohol on the premises;
- (b) during the first twenty minutes after the above hours, the taking of the alcohol from the premises unless the alcohol is supplied or taken in an open vessel;
- (c) during the first thirty minutes after the above hours the consumption of the alcohol on the premises by persons taking table meals there if the alcohol was supplied for consumption as ancillary to the meals;
- (d) the sale or supply of alcohol to or the consumption of alcohol by any person residing in the licensed premises;
- (e) the ordering of alcohol to be consumed off the premises, or the despatch by the vendor of the alcohol so ordered;

- (f) the sale of alcohol to a trader or registered club for the purposes of the trade or club;
- (g) the sale or supply of alcohol to any canteen or mess, being a canteen in which the sale or supply of alcohol is carried out under the authority of the Secretary of State or an authorised mess of members of Her Majesty's naval, military or air forces;
- (h) the taking of alcohol from the premises by a person residing there;
- (i) the supply of alcohol for consumption on the premises to any private friends of a person residing there who are bona fide entertained by him at his own expense, or the consumption of alcohol by persons so supplied;
- (j) the supply of alcohol for consumption on the premises to persons employed there for the purposes of the business carried on by the holder of the licence, or the consumption of liquor so supplied, if the liquor is supplied at the expense of their employer or of the person carrying on or in charge of the business on the premises.

In this condition, any reference to a person residing in the premises shall be construed as including a person not residing there but carrying on or in charge of the business on the premises.

33. No person under fourteen shall be in the bar of the licensed premises during the permitted hours unless one of the following applies:

- (a) He is the child of the holder of the premises licence.
- (b) He resides in the premises, but is not employed there.
- (c) He is in the bar solely for the purpose of passing to or from some part of the premises which is not a bar and to or from which there is no other convenient means of access or egress.
- (d) The bar is in railway refreshment rooms or other premises constructed, fitted and intended to be used bona fide for any purpose to which the holding of the licence is ancillary.

In this condition "bar" includes any place exclusively or mainly used for the consumption of intoxicating liquor. But an area is not a bar when it is usual for it to be, and it is, set apart for the service of table meals and alcohol is only sold or supplied to persons as an ancillary to their table meals.

34. If any entertainment is provided for children or if an entertainment is provided at which the majority of persons attending are children, then, if the number of children attending the entertainment exceeds 100, it shall be the duty of the holder of the premises licence (or the holder of the club premises certificate):

- (a) to station and keep stationed wherever necessary a sufficient number of adult attendants, properly instructed as to their duties, to prevent more children or other persons being admitted to the building, or to any part thereof, than the building or part can properly accommodate,
- (b) to control the movement of the children and other persons admitted while entering and leaving the building or any part thereof, and
- (c) to take all other reasonable precautions for the safety of the children.

35. The terminal hour for late night refreshment on New Year's Eve is extended to 05:00 on New Year's Day.

## **Annex 2 – Conditions consistent with the operating Schedule**

36. No person shall be admitted to the membership of the premises without an interval of at least 24 hours between application for membership and admission. A register of membership shall be maintained on the premises and made available to member of the statutory authority upon request.
37. When open to patrons, at least one registered door supervisor will remain on the premises. An up to date record of all names, badge numbers and times worked of all door supervisors will be maintained daily and made available on request to the Metropolitan Police and the Licensing Authority.
38. There shall be a personal licence holder on duty on the premises at all times when the premises are authorised to sell alcohol and are open and trading to the public.
39. An incident log shall be kept at the premises, and made available on request to an authorised officer of the City Council or the Police, which will record the following:
  - (a) all crimes reported to the venue
  - (b) all ejections of patrons
  - (c) any complaints received
  - (d) any incidents of disorder
  - (e) all seizures of drugs or offensive weapons
  - (f) any faults in the CCTV system or searching equipment or scanning equipment
  - (g) any refusal of the sale of alcohol
  - (h) any visit by a relevant authority or emergency service
40. The premises shall install and maintain a comprehensive CCTV system as per the minimum requirements of the Westminster Police Licensing Team. All entry and exit points will be covered enabling frontal identification of every person entering in any light condition. The CCTV system shall continually record whilst the premises is open for licensable activities and during all times when customers remain on the premises. All recordings shall be stored for a minimum period of 31 days with date and time stamping. Recordings shall be made available immediately upon the request of Police or authorised officer throughout the preceding 31 day period.
41. A staff member from the premises who is conversant with the operation of the CCTV system shall be on the premises at all times when the premises is open to the public. This staff member must be able to show a Police or authorised council officer recent data or footage with the absolute minimum of delay when requested.
42. In the event that a serious assault is committed on the premises (or appears to have been committed) the management will immediately ensure that:
  - (a) The Police (and where appropriate, the London Ambulance Service) are called without delay, using emergency telephone number 999;
  - (b) All measures that are reasonably practicable are taken to apprehend any suspects pending the arrival of the Police;
  - (c) As is reasonably practicable, the crime scene is preserved so as to enable a full forensic investigation to be carried out by the Police; and
  - (d) Such other measures are taken (as appropriate) to fully protect the safety of all persons present on the premises."'Serious assault' includes (but is not limited to) any assault in which emergency medical treatment is required and any assault in which a weapon is used.

### **Annex 3 – Conditions attached after a hearing by the licensing authority**

43. Sale of alcohol is permitted on Mondays to Saturdays:
- (a) Subject to the following paragraphs, the permitted hours on Monday to Saturday shall commence at 10.00 and extend until 05.00 on the morning following, except that -
    - (i) the permitted hours shall end at 00.00 midnight on any day on which music and dancing is not provided after midnight; and
    - (ii) on any day that music and dancing end between 00.00 midnight and 05.00, the permitted hours shall end when the music and dancing end;
  - (b) In relation to the morning on which summer time begins, paragraph (a) of this condition shall have effect-
    - (i) with the substitution of references to 06.00 for references to 05.00.
  - (c) The sale of alcohol must be ancillary to the use of the premises for music and dancing and substantial refreshment.
  - (d) The permitted hours on New Year's Eve will extend to the start of permitted hours on the following day, or if there are no permitted hours on 1 January, to 00.00 on New Year's Eve.

NOTE – The above restrictions do not prohibit:

- (a) during the first thirty minutes after the above hours the consumption of the alcohol on the premises;
- (b) during the first twenty minutes after the above hours, the taking of the alcohol from the premises unless the alcohol is supplied or taken in an open vessel;
- (c) the sale or supply of alcohol to or the consumption of alcohol by any person residing in the licensed premises;
- (d) the ordering of alcohol to be consumed off the premises, or the despatch by the vendor of the alcohol so ordered;
- (e) the sale of alcohol to a trader or registered club for the purposes of the trade or club;
- (f) the sale or supply of alcohol to any canteen or mess, being a canteen in which the sale or supply of alcohol is carried out under the authority of the Secretary of State or an authorised mess of members of her Majesty's naval, military or air forces;
- (g) the taking of alcohol from the premises by a person residing there;
- (h) the supply of alcohol for consumption on the premises to any private friends of a person residing there who are bona fide entertained by him at his own expense, or the consumption of alcohol by persons so supplied;
- (i) the supply of alcohol for consumption on the premises to persons employed there for the purposes of the business carried on by the holder of the licence, or the consumption of liquor so supplied, if the liquor is supplied at the expense of their employer or of the person carrying on or in charge of the business on the premises.

In this condition, any reference to a person residing in the premises shall be construed as including a person not residing there but carrying on or in charge of the business on the premises.

44. The entrance door to the club shall remain closed (except for access and egress) whenever regulated entertainment is being provided.

45. The windows to the front elevation of the Club shall be kept shut whenever regulated entertainment is being provided.
46. The Exhibition of Films is permitted from the end of permitted hours on New Year's Eve to the start of permitted hours the following day.
47. The Exhibition of Films is permitted for an extra hour added to the terminal hour when Greenwich Mean Time changes to British Summer Time.
48. The number of staff accommodated on the premises shall be reduced on a pro rata basis after 03:00 hours to correspond with the number of customers on the premises, being no more than 20 customers at any time after 03:00 hours.
49. All kitchen and bar areas shall have a designated rubbish receptacle. All refuse is paid for, properly presented and can only be placed on the highway for collection 30 minutes before the schedule collection times.

\* Conditions indicated shall not apply when a Sexual Entertainment Licence is in effect at the premises

## SEX ESTABLISHMENT LICENCE

### Sexual Entertainment Venue

Premises licence number:	15/08368/LISEVR
Original Reference:	12/02681/LISEVN

The CITY OF WESTMINSTER, under the provisions of the Local Government (Miscellaneous Provisions) Act 1982 as amended by the Policing and Crime Act 2009

hereby licences:  
to use the premises:

**LEASERISE LTD**  
**No.4 MAYFAIR**  
**FIRST FLOOR**  
**4 MILL STREET**  
**LONDON**  
**W1S 2AX**

as a Sexual Entertainment Venue.

This licence commences from the **01 October 2015** and will expire on the **30 September 2016**.

Relevant Entertainment (namely a hostess bar and striptease involving full nudity) may be provided during the following times:

Monday to Saturday	09:00 to 05:00
Sunday	12:00 to 22:30

Relevant Entertainment may only be provided in the permitted areas outlined in red shown on the plans attached at Appendix 1.

This licence is granted subject to the conditions attached at Appendix 2.



DATE: 17.11.15

SIGNED:

**On behalf of the Operational Director -  
Premises Management**

# Appendix 1 – Plans

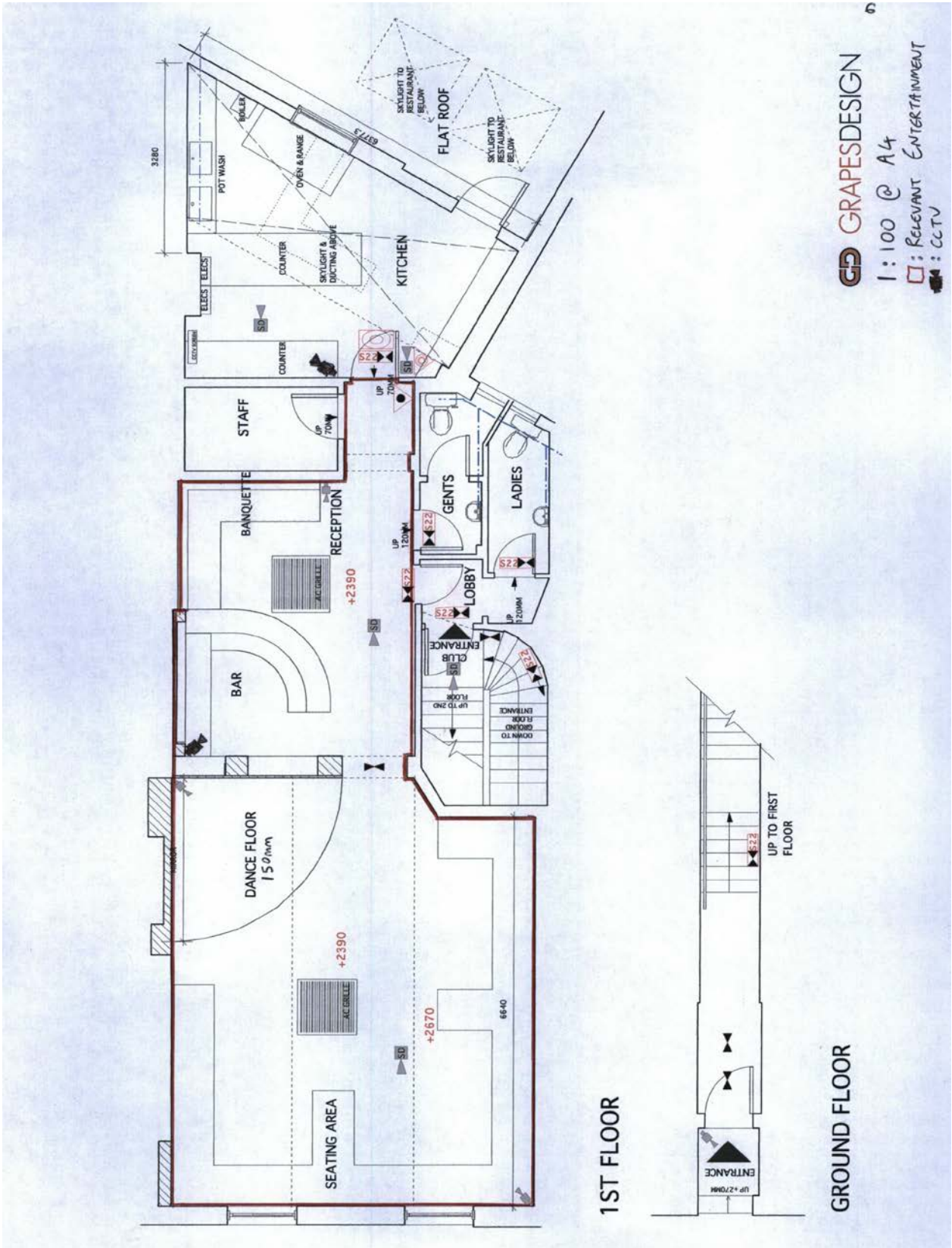

## Appendix 2 – Conditions

### Standard Conditions:

1. Whilst Relevant Entertainment is taking place no person under the age of 18 shall be on the licensed premises and a clear notice to that effect shall be displayed at the entrance in a prominent position so that it can be easily read by persons entering the premises.
2. Whenever persons under the age of 18 are admitted to the premises there will be no promotional or other material on display within the premises which depicts nudity or partial nudity.
3. The licence or a clear copy shall be prominently displayed at all times so as to be readily and easily seen by all persons using the premises.
4. No provision of relevant entertainment, or material depicting nudity or relevant entertainment, shall be visible from outside the premises.
5. Menus and drinks price lists shall be clearly displayed at the front entrance of the club, reception area, tables and bar at such a position and size as to be easily read by customers. This price list shall show all consumable items and any minimum tariff including charges and fees applicable to Performers.
6. Except with the consent of the Licensing Authority, no advertisements of any kind (including placard, poster, sticker, flyer, picture, letter, sign or other mark) shall be inscribed or affixed at the premises, on the surface of the highway or on any building, structure, works, street furniture, tree or any other property or be distributed in the street to the public that advertises or promotes the relevant entertainment at the premises.
7. The licence holder or other person concerned in the conduct or management of the premises shall not seek to obtain custom by means of personal solicitation or touting, nor enter into any agreement with a third party to do so.
8. Adequate toilets, washing and changing facilities for use by the Performers shall be provided.
9. Either the licence holder or a named responsible person shall be present throughout the time the Relevant Entertainment takes place.
10. The premises will install and maintain a comprehensive CCTV system as per the minimum requirements of a Metropolitan Police Crime Prevention Officer that ensures all areas of the licensed premises are monitored including all entry and exit points will be covered enabling frontal identification of every person entering any light condition. All cameras shall continually record whilst the premises is open for licensable activities and during all times when customers remain on the premises. All recordings shall be stored for a minimum period of 31 days with date and time stamping. Recordings shall be made available immediately upon the request of Police or authorised officer throughout the preceding 31 day period together with facilities for viewing.



11. A staff member from the premises who is conversant with the operation of the CCTV system shall be on the premises at all times when the premises is open to the public and this staff member should be able to show Police recent data and footage with the absolute minimum of delay of the request.
12. An incident log shall be kept at the premises, and made available on request to the Licensing Authority or the Police, which will record the following:
  - (a) all crimes reported to the venue;
  - (b) all ejections of patrons;
  - (c) any complaints received;
  - (d) any incidents of disorder;
  - (e) seizures of drugs or offensive weapons;
  - (f) any faults in the CCTV system or searching equipment or scanning equipment;
  - (g) any refusal of the sale of alcohol;
  - (h) any visit by a relevant authority or emergency service;
  - (i) any breach of licence conditions reported by a Performer
13. The licence holder shall produce a Code of Conduct setting out rules and obligations between the licence holder and performers whilst performing. All Performers shall sign the Code of Conduct in their proper name acknowledging that they have read, understood and are prepared to abide by the said Code of Conduct, and a copy so signed shall be retained by the licence holder and shall be readily available for inspection by the Police and/or authorised persons upon reasonable request.
14. Individual records shall be kept at the premises of the real names, stage names and addresses of all Performers working at the premises. The record will include either a copy of their birth certificate, current passport, EU driving licence or national identity card and shall be made immediately available for inspection by the Police and/or the Licensing Authority upon request.
15. Details of all work permits and/or immigration status relating to persons working at the premises shall be retained by the licence holder and be readily available for inspection by the Licensing Authority, a Police Officer or Immigration Officer.
16. Relevant Entertainment shall be given only by Performers and the audience shall not be permitted to participate in the relevant entertainment.
17. There shall be no physical contact between Performers whilst performing.
18. Performers will not request or give out any telephone number, address or any other contact information from or to any customer. Any such information given by a customer shall be surrendered to the premises manager as soon as is practicable.
19. Relevant Entertainment shall take place only in the designated areas approved by the Licensing Authority as shown on the licence plan. Arrangements for access to the dressing room shall be maintained at all times whilst Relevant Entertainment is taking place and immediately thereafter.

20. Customers must remain fully clothed at all times. The Performer must not remove any of the customer's clothing at any time.
21. Where Relevant Entertainment is provided in booths, or other areas of the premises where private performances are provided, the booth or area shall not have a door or other similar closure, the area shall be constantly monitored by CCTV, and access to the booth or other area shall be adequately supervised.
22. Whenever Relevant Entertainment is being provided there shall be no physical contact between Performers and customers or between customers and Performers except for the exchanging of money or tokens at the beginning or conclusion of the performance and only for the purpose of that performance. Clearly legible notices to this effect shall clearly be displayed in each private booth and in any performance area.
23. Performers must redress fully immediately after each performance.

Additional Conditions:

24. External windows shall be rendered opaque when relevant entertainment takes place.
25. No Relevant Entertainment shall take place at the premises until a wash basin is provided in the staff room to the satisfaction of the Environmental Health Consultation Team.
26. The maximum number of persons accommodated at any one time (excluding staff) shall not exceed 30 persons. On a Monday to Friday after 03.00 hours (the following morning) the maximum number of persons shall be 20 persons (excluding staff).
27. All emergency doors shall be maintained effectively self closing and not held open other than by an approved device.
28. The edges of the treads of steps and stairways shall be maintained so as to be conspicuous.
29. Curtains and hangings shall be arranged so as not to obstruct emergency signs.
30. The approved arrangements at the premises, including means of escape provisions, emergency warning equipment, the electrical installation and mechanical equipment, shall at all material times be maintained in good condition and full working order.
31. The means of escape provided for the premises shall be maintained unobstructed, free of trip hazards, be immediately available and clearly identified in accordance with the plans provided.
32. All exit doors shall be available at all material times without the use of a key, code, card or similar means.

33. Any special effects or mechanical installations shall be arranged and stored so as to minimise any risk to the safety of those using the premises. The following special effects will only be used on 10 days prior notice being given to the Licensing Authority where consent has not previously been given.
- i. pyrotechnics including fire works
  - ii. firearms
  - iii. lasers
  - iv. explosives and highly flammable substances.
  - v. real flame.
  - vi. strobe lighting.
34. No noise shall emanate from the premises nor vibration be transmitted through the structure of the premises which gives rise to a nuisance.



# No.4 Mayfair, 4 Mill Street



Residential / Proposed Residential	26
Under Construction	Not known
Other Uses	Not known
Proportion Residential of all Uses	Not known

10  
 Meters

This product includes mapping data licensed from Ordnance Survey with the permission of the Controller of Her Majesty's Stationery Office. © Crown copyright and/or database right 2013. All rights reserved. Licence number LA 100019597

Data Source: Uniform Database  
 Date: 26/10/2016